

Motor Types:

SD 21 SD 41 SD 8
SD 38 SD 28 SD 29

1 or 3 Phase Induction Motors – Constant Speed
Shaded Pole, Permanent Capacitor or Synchronous
 Enclosures: Standard – Ventilated Internal Fan Cooled (IP 20)
 Alternative – Totally Enclosed (IP 50) with Terminal Box or T.E.F.C. (IP 54)



SD 21



SD 8



SD 38



SD 8 with brake

- **Voltage Range:** 100/120v – 220/240v A.C. single phase, 50Hz. 380/440 A.C. three phase, 50Hz. Special voltages and frequencies quoted on request.
- **Motor Type:** Single phase with separate capacitor or three phase induction, suitable for reversing. Shaded pole (not reversible) **anti-clockwise** rotation as standard.
- **Starting Currents:** Capacitor or three phase induction: approx 2.5 times full load. Shaded pole: approx 2 times full load.
- **Construction: Motors** – Shielded ball bearings spring loaded for quiet running.
Single Reduction Gearboxes: Fitted with ball bearings, alloy gearbox with composite gear wheel, grease lubricated for life and suitable for mounting in any position.
In-Line Double Reduction Gearboxes: Fitted with ball bearings, alloy gearbox with composite gear wheel, grease or oil bath lubricated for life and suitable for mounting in any position.
Spur Reduction Gearboxes: Fitted with ball bearings, alloy gearbox with composite pinion wheel and multi-spur type hardened steel gears, oil bath lubricated for life. Suitable for mounting in any position.
- **Connections:** 30cm P.V.C. flexible (SD 38 and SD 29 terminal box).
- **Insulation:** Class 'F' (maximum temperature rise 115°C at a maximum ambient of 40°C).
- **Specifications:** B.S. 5000 part 11. (I.E.C. 72). (CSA C-US if required).

- **Optional Extras:** Double ended motor spindles.
 Double ended gear shafts, (not available on in-line units).
 Non standard shafts (stainless steel, keyways, flats, etc).
 Terminal box (not available on SD 21).
 Totally enclosed frame half hour rating.
 Totally enclosed fan cooled frame (T.E.F.C.), continuous rating. (SD 8/SD 28 only).
 Enclosure IP 65 on request.
 Thermal overload protection.
- **Electro-Magnetic Brake:** Page 6.
- **Tachogenerator:** Page 117.
- **Additional Extras for Geared Units:** Non standard catalogue reductions maybe available on request.
- **Bronze Gears:** (Single and double reduction final gears).
- **Flange Mounting Gearbox Details:** Page 114.
- **Gearbox Shaft Positions:** Page 113.

| SD 21 | Single Phase | | | | | |
|---------------------|------------------|--------------|---------------------------|----------------|-----------------------------|---|
| | Shaded Pole | | | | | |
| | FULL LOAD R.P.M. | OUTPUT WATTS | STARTING TORQUE FULL LOAD | CURRENT (AMPS) | | INPUT WATTS |
| 240V | | | | 220V | TOTALLY ENCLOSED CONTINUOUS | |
| 1400 | 3.7 | 50% | 0.22 | 0.2 | 30 | |
| 1400 | 8 | 80% | 0.3 | 0.29 | 45 | VENTILATED – CONTINUOUS TOTALLY ENCLOSED – 1/2 HR |
| Permanent Capacitor | | | | | | |
| | | | M.F.D. | | | |
| 1400 | 8 | 100% | 0.18 | 0.16 | 40 | 240V 220V |
| 2800 | 20 | 85% | 0.34 | 0.3 | 80 | 2 2 |

| SD 41 | Single Phase | | | | | | |
|-------------|---------------------|--------------|---------------------------|----------------|------|-------------|--------------------|
| | Permanent Capacitor | | | | | | |
| | FULL LOAD R.P.M. | OUTPUT WATTS | STARTING TORQUE FULL LOAD | CURRENT (AMPS) | | INPUT WATTS | CAPACITOR (M.F.D.) |
| 240V | | | | 220V | 240V | | 220V |
| 1400 | 10 | 100% | 0.2 | 0.19 | 40 | 3 | 3 |
| 2800 | 25 | 100% | 0.25 | 0.24 | 65 | 2.5 | 2.5 |
| Three Phase | | | | | | | |
| | | | 440V | 380V | | | |
| 1400 | 10 | 150% | 0.14 | 0.12 | 47 | | |
| 2800 | 25 | 150% | 0.14 | 0.12 | 58 | | |

| SD 8 SD 38 | Single Phase | | | | | | |
|---------------------------------|---------------------|--------------|---------------------------|----------------|------|-------------|--------------------|
| | Permanent Capacitor | | | | | | |
| | FULL LOAD R.P.M. | OUTPUT WATTS | STARTING TORQUE FULL LOAD | CURRENT (AMPS) | | INPUT WATTS | CAPACITOR (M.F.D.) |
| 240V | | | | 220V | 240V | | 220V |
| 900 | 10 | 100% | 0.2 | 0.22 | 45 | 2 | 2 |
| 1400 | 35 | 85% | 0.3 | 0.3 | 75 | 2.5 | 2.5 |
| 2800 | 60 | 75% | 0.57 | 0.53 | 127 | 4 | 4 |
| Two Speed Permanent Capacitor | | | | | | | |
| 1400 | 30 | 50% | 0.43 | 0.4 | 85 | 6 | 6 |
| 2800 | 50 | 50% | 0.47 | 0.48 | 110 | 6 | 6 |
| Synchronous Permanent Capacitor | | | | | | | |
| 1500 (syn) | 10 | 100% | 0.26 | 0.23 | 55 | 5 | 5 |

| SD 8 SD 38 | Three Phase | | | | | |
|---------------|------------------|--------------|---------------------------|----------------|------|-------------|
| | FULL LOAD R.P.M. | OUTPUT WATTS | STARTING TORQUE FULL LOAD | CURRENT (AMPS) | | INPUT WATTS |
| | | | | 440V | 380V | |
| 900 | 15 | 100% | 0.2 | 0.17 | 80 | |
| 1400 | 35 | 200% | 0.24 | 0.22 | 80 | |
| 2800 | 60 | 200% | 0.24 | 0.22 | 105 | |
| Two Speed | | | | | | |
| 1400 | 30 | 100% | 0.21 | 0.18 | 90 | |
| 2800 | 50 | 100% | 0.16 | 0.17 | 90 | |
| Synchronous | | | | | | |
| 1500 (syn) | 10 | 100% | 0.22 | 0.21 | 60 | |

| SD 28 SD 29 | Single Phase | | | | | | |
|----------------|---------------------|--------------|---------------------------|----------------|------|-------------|--------------------|
| | Permanent Capacitor | | | | | | |
| | FULL LOAD R.P.M. | OUTPUT WATTS | STARTING TORQUE FULL LOAD | CURRENT (AMPS) | | INPUT WATTS | CAPACITOR (M.F.D.) |
| 240V | | | | 220V | 240V | | 220V |
| 1400 | 55 | 85% | 0.41 | 0.46 | 100 | 3 | 4 |
| 2800 | 100 | 85% | 0.76 | 0.75 | 185 | 6 | 6 |
| Three Phase | | | | | | | |
| | | | 440V | 380V | | | |
| 1400 | 55 | 150% | 0.28 | 0.25 | 120 | | |
| 2800 | 120 | 150% | 0.36 | 0.38 | 210 | | |

**SD 21
SD 41**

Dimensions in mm. Scale 1:5

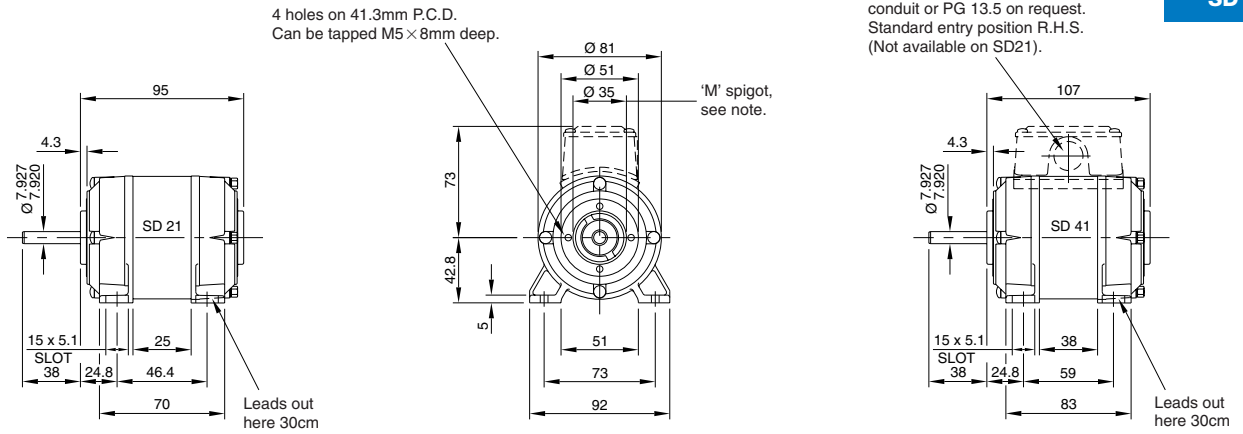

Spigot 'M' can be machined to 34.54/34.49mm dia. concentric with shaft 0.05mm T.I.R.
Optional shaft at lead end, 7.93mm dia. x 33mm long.

Approx. weight: SD 21 – 1.54 Kg
SD 41 – 2.10 Kg

**SD 8
SD 28**

Dimensions in mm. Scale 1:5

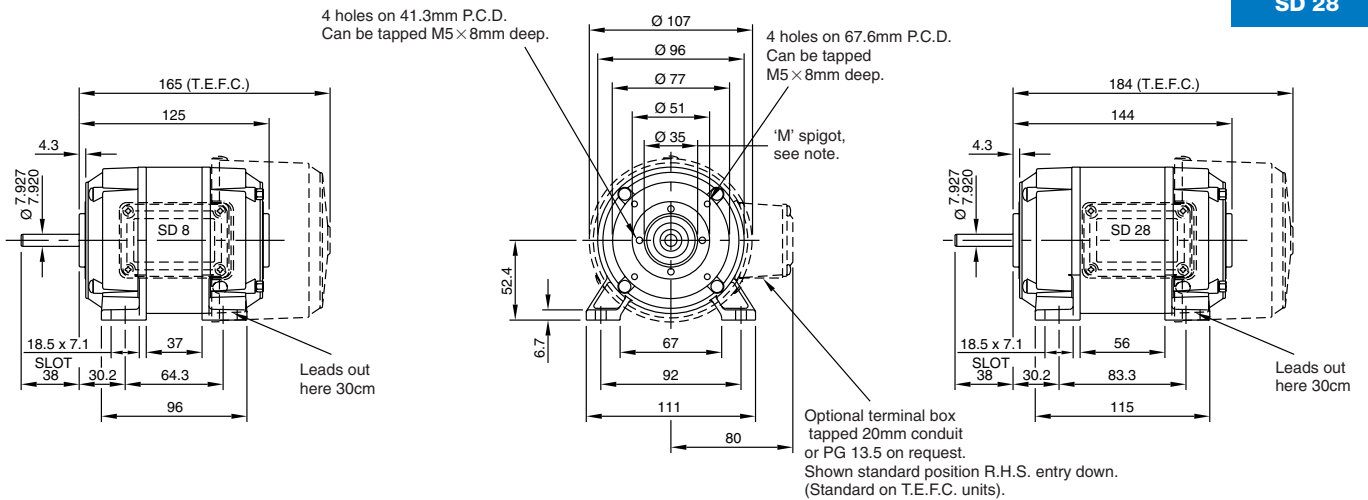

Spigot 'M' can be machined to 34.54/34.49mm dia. concentric with shaft 0.05mm T.I.R.
Optional shaft at lead end see separate drawing for details. Not applicable to T.E.F.C. units.

Approx. weight: SD 8 – 2.80 Kg
SD 28 – 3.60 Kg

**SD 38
SD 29**

Dimensions in mm. Scale 1:5

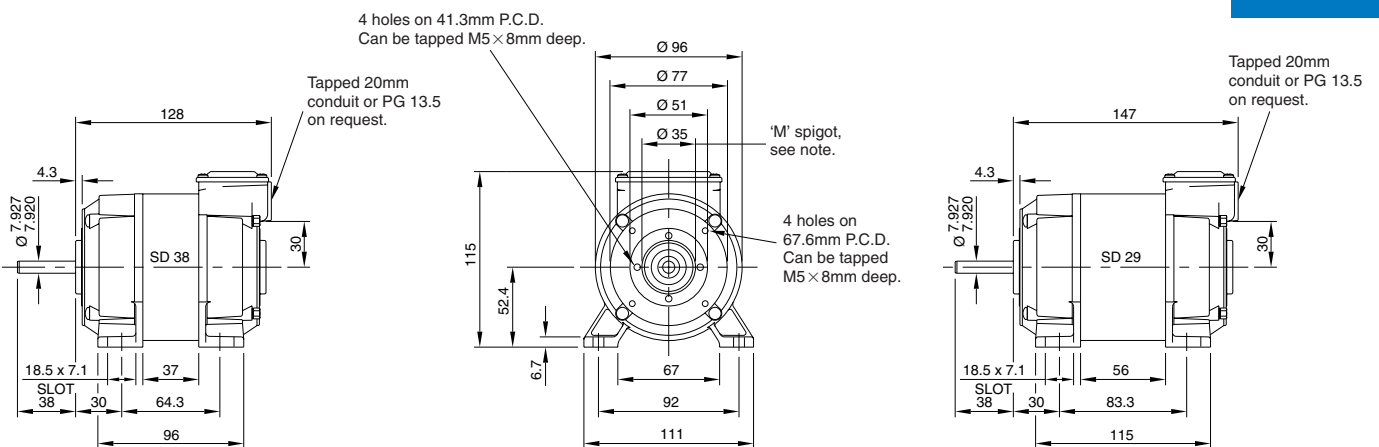

Spigot 'M' can be machined to 34.54/34.49mm dia. concentric with shaft 0.05mm T.I.R.
Optional shaft at terminal box end see separate drawing for details.

Approx. weight: SD 38 – 2.85 Kg
SD 29 – 3.62 Kg

Non-drive end extension (optional)

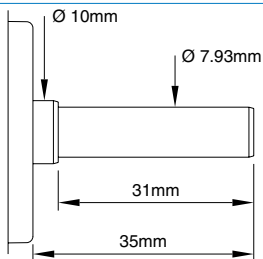

**SD 8 SD 38
SD 28 SD 29**