

# SD21 (2-POLE) AC motor

Ø81 mm frame // 25 mm stack

all dimensions in mm

**parvalux**  
by **maxon**

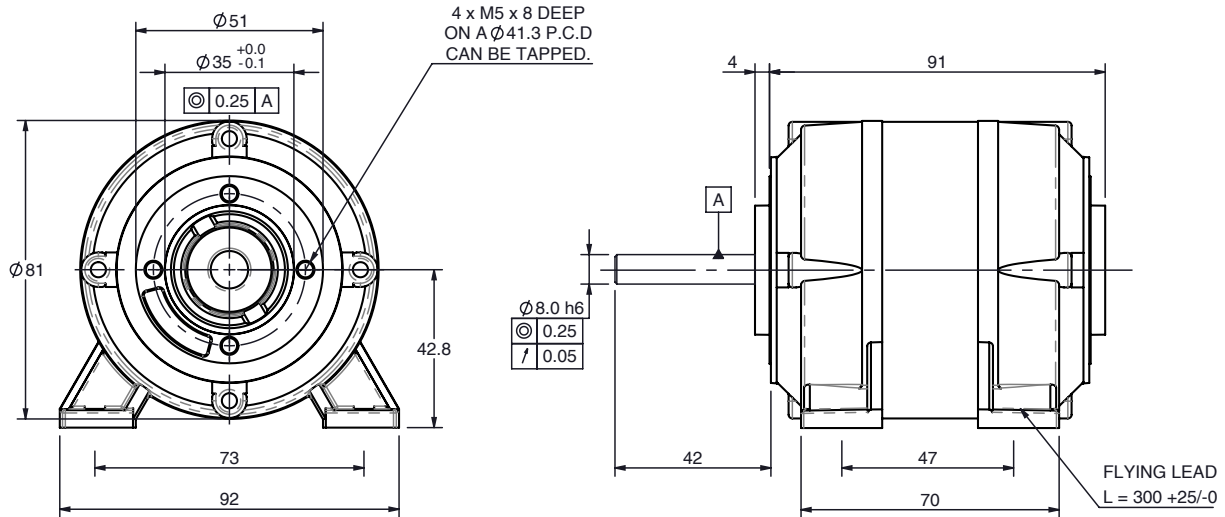

## Part number key

Modular	#####
Standard	#####
Calculated data	#####

Please see our customisation options page for details on the modifications available on our products. Advice and guidance on these options are available from your local sales engineer.

Note: Feet optional on this motor - please contact your local sales engineer for more information.

## Technical data

1 Part number		-	-
2 Phases		1	1
3 Frequency	Hz	50	60
4 Nominal voltage	V AC	230/115	230/115
5 Nominal power	W	20	20
6 Nominal speed	rpm	2800	3400
7 Nominal continuous torque (S1)	Nm	0.07	0.06
8 Nominal continuous current (S1)	A	0.34	0.60
9 Starting Current	A	0.85	1.50
10 Input power	W	80	80
11 Capacitor Value	M.F.D	2.0	2.0/8.4
12 Starting torque full load	%	85	85
13 Stack length	mm	25	25
14 Number of poles		2	2
15 Rotor inertia	Kg/cm <sup>2</sup>	-	-

## Thermal data

16 Ambient temperature	°C	40
------------------------	----	----

## Mechanical data

17 Radial load [distance from flange]	N [mm]	110 [15]
---------------------------------------	--------	----------

## Other data

18 Weight	Kg	1.5
19 Enclosure		VENT/TE
20 IP Rating - Ventilated		IP20
21 IP Rating - TE/TEFC		IP54
22 Insulation Class		F
23 Type		Permanent capacitor, asynchronous
24 Direction		Reversible

## Compatible products

Gearbox	Page #	Brake	Page #
S Box	216	1.5 Nm	258
GB28	218	2.0 Nm	259
GB58	219		
SWS	220		
M Box	222		
PGx42	248		
GB36	231		
LWS	236		

Encoder	Page #
On request	-

## Key

Standard combination

Modular combination

# SD21 (2-POLE) combinations

Quickview - combination drawing and technical data

**parvalux**  
by **maxon**

Combination drawing		Technical data							
SD21-S-Box		Gear material <sup>1</sup>	Comp.	Comp.	Comp.	Bronze	Bronze	Bronze	
		Gear ratio <sup>2</sup>	:1	4	30	70	4	30	70
		Speed <b>rpm</b>	850.0	113.3	48.6	850.0	113.3	48.6	
		Nominal torque <b>Nm</b>	0.2	1.2	1.7	0.2	1.0	1.5	
SD21-GB28		Gear material <sup>1</sup>	Comp.	Comp.	Comp.	Bronze	Bronze	Bronze	
		Gear ratio <sup>2</sup>	:1	-	-	-	15	30	60
		Speed <b>rpm</b>	-	-	-	226.7	113.3	56.7	
		Nominal torque <b>Nm</b>	-	-	-	0.7	1.2	1.6	
SD21-GB58		Gear material <sup>1</sup>	Comp.	Comp.	Comp.	Bronze	Bronze	Bronze	
		Gear ratio <sup>2</sup>	:1	4	15	25	-	-	-
		Speed <b>rpm</b>	850.0	226.7	136.0	-	-	-	
		Nominal torque <b>Nm</b>	0.2	0.7	1.0	-	-	-	
SD21-SWS		Gear material <sup>1</sup>	Comp.	Comp.	Comp.	Bronze	Bronze	Bronze	
		Gear ratio <sup>2</sup>	:1	36	207	1364	-	-	-
		Speed <b>rpm</b>	94.4	16.4	2.5	-	-	-	
		Nominal torque <b>Nm</b>	1.5	8.8	11.0	-	-	-	
SD21-M-Box		Gear material <sup>1</sup>	Comp.	Comp.	Comp.	Bronze	Bronze	Bronze	
		Gear ratio <sup>2</sup>	:1	4	30	72	4	30	72
		Speed <b>rpm</b>	850.0	113.3	47.2	850.0	113.3	47.2	
		Nominal torque <b>Nm</b>	0.2	1.3	2.0	0.2	1.1	1.7	
SD21-PGx42		Gear material <sup>1</sup>	Comp.	Comp.	Comp.	Bronze	Bronze	Bronze	
		Gear ratio [stages] <sup>2</sup>	:1	-	-	-	3.5 [1]	353 [4]	936 [4]
		Speed <b>rpm</b>	-	-	-	971.4	9.6	3.6	
		Nominal torque <b>Nm</b>	-	-	-	0.2	11.3	11.3	
SD21-GB36		Gear material <sup>1</sup>	Comp.	Comp.	Comp.	Bronze	Bronze	Bronze	
		Gear ratio <sup>2</sup>	:1	24	120	1400	-	-	-
		Speed <b>rpm</b>	141.7	28.3	2.4	-	-	-	
		Nominal torque <b>Nm</b>	1.1	5.3	45.0	-	-	-	
SD21-LWS		Gear material <sup>1</sup>	Comp.	Comp.	Comp.	Bronze	Bronze	Bronze	
		Gear ratio <sup>2</sup>	:1	48	672	3450	-	-	-
		Speed <b>rpm</b>	70.8	5.1	1.0	-	-	-	
		Nominal torque <b>Nm</b>	2.0	26.2	100.0	-	-	-	

## Key

Standard combination / standard gear ratio

**Modular combination / modular gear ratio**

## Notes

<sup>1</sup> Comp. = Composite gears

<sup>2</sup> Full gear ratio options displayed on individual gearbox datasheets

→ Technical data displayed above calculated based on **SD21 (2-POLE) 1 Phase 60Hz** motor.

→ Simplified drawings displayed above show overall envelope size of the combination. Please see individual motor and gearbox datasheets for detailed technical drawings.