

BRx90-75 PMDC motor

Ø90 mm frame // 75 mm stack

parvalux
by **maxon**

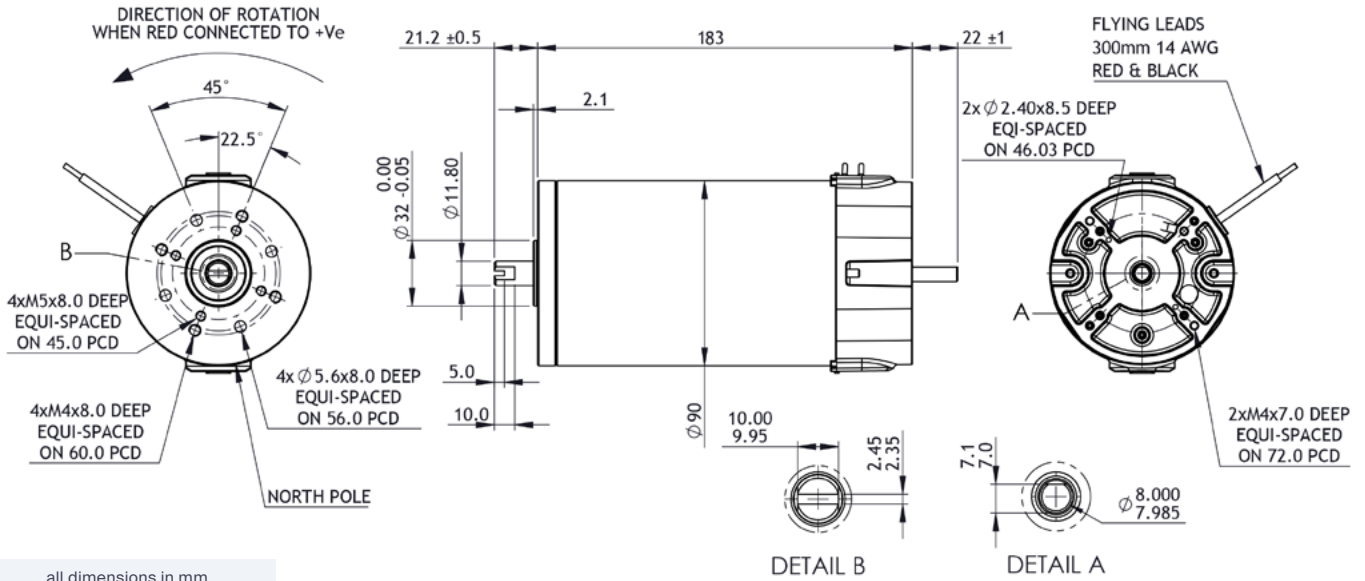

all dimensions in mm

Part number key

Modular	#####
Standard	#####
Calculated data	#####

Technical data

		781106	781107	781108
1 Part number		781106	781107	781108
2 Nominal power	W	236	283	283
3 Nominal voltage	V	12	24	48
4 No load speed	rpm	3750	3417	3376
5 No load current	A	3.4	1.2	0.6
6 Nominal speed	rpm	2500	3000	3000
7 Nominal continuous torque (S1)	Nm	0.9	0.9	0.9
8 Nominal continuous current (S1)	A	33.2	14.5	7.3
9 Max. intermittent torque (S2 - 15 minutes)	Nm	1.50	1.50	1.50
10 Stall current	A	83.5	93.0	58.0
11 Stall torque	Nm	2.38	6.14	7.71
12 Stack length	mm	75	75	75
13 Maximum efficiency	%	69	79	80
14 Terminal resistance - phase to phase	Ω	0.116	0.312	0.426
15 Terminal inductance - phase to phase	mH	78.3	422.3	1620.0
16 Speed constant	rpm/V	311.3	135.9	68.0
17 Torque constant	Nm/A	0.03	0.07	0.13
18 Speed torque gradient	rpm/Nm	1667.4	547.1	433.0
19 Rotor inertia	Kgcm²	8.65 x 10 ⁻⁴	8.65 x 10 ⁻⁴	8.65 x 10 ⁻⁴

Thermal data

20 Ambient temperature	°C	40
------------------------	-----------	----

Mechanical data

21 Radial load [distance from flange]	N [mm]	200 [15]
---------------------------------------	---------------	----------

Other data

22 Number of poles		2
23 Weight	Kg	4.00
24 IP rating		IP54
25 Enclosure		Enclosed
26 Insulation Class		F
27 Reversible		Yes

Modular system

Gearbox	+L mm	Brake	+L mm	Controller
GB9	138	1.5 Nm	28.2	SC 50/15
GB12	110			
Encoder	+L mm			
Incremental	9			

Compatible products key

Product name	Standard combination
Product name	Modular combination

+L mm = approximate added length*

*additional length may also be required for mounting flange between components